

UNRIVALED CLASS

Emilean

R E S I D E N C E



DEVELOPMENT



LTD

ARCHITECTURAL GROUP

KEY

Designed by: KEY ARCHITECTURAL GROUP

UNRIVALED CLASS

The **Emilean** goes far as a residence with its outstanding **CHARACTER**, through its emphasis on encapsulating the **BEAUTY** of Accra with its curves and fine edges; creating a **FLOW** that bonds modernity and evolutive Ghanaian culture and provides a crossroad between Ghana's past, present and future with its unique and **BOLD** statements.

Emilean
RESIDENCE





The **Emilean** outlines the necessary lifestyle for luxurious living! With its classy studios, elegant duplex apartments and mesmerizing penthouse, The **Emilean** emphasizes the role of natural beauty in harmony with the urban landscape as a form of architectural evolution. Proficiently illustrated to appeal to the most refined tastes,

all apartments adapt to the ideal ambiance for the flow of our moods. The clubhouse specifically features a private infinity pool that captures the splendor of the city skyline. The **Emilean** further exudes its luxury through a fully equipped air conditioned executive gym, a well ventilated underground parking, and elevated terraces.





THE EMBODIMENT OF LUXURY LIVING

The **Emilean** highlights the importance of quality comfort, unique architecture and modern **luxury**; which translates to melodic living. Enriched with its surrounding nature, The **Emilean** has been consciously designed to favor its residents' desires.



Emilean residence defines excellence with a straight 5-star, a perfect destination of living in **luxury** in **Accra** with the beauty of all facades located along the most prestigious streets of Cantonments.

The siting of the **Emilean** facilitates easy accessibility to restaurants, embassies, banking halls, shopping centres, schools, hospitals and other social amenities.



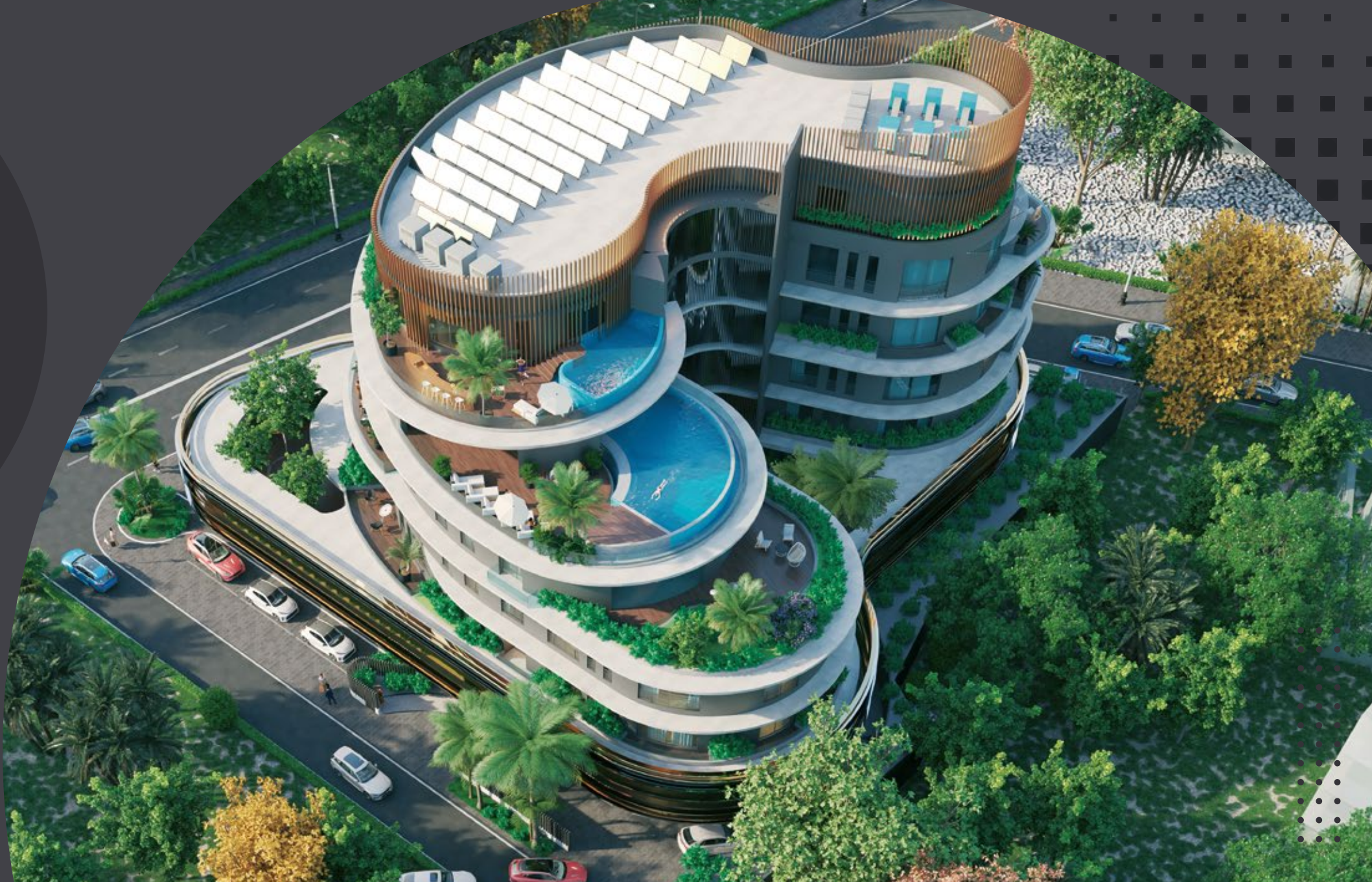



STEP OUTSIDE THE FLOW!

Through its immaculate architecture and elaborate details, The **Emilean** is distinctively shaped to capture the conspicuous nature of **Accra**, a city in which modernism and culture flow as one; providing an abundant personality that delivers **exquisite** designs and exceptional standards.

SUSTAINABILITY

The highest class of architecture blends harmoniously with nature. Thus, we take delight in the collective efforts exercised by our team to preserve **60%** of the existing trees and reforesting more than **200 trees** and plants on this project; establishing our core values on sustainable development. The **Emilean** is intended to compliment **Accra's** nature rather than taking away from it, offering an environment where the **clean air**, light, thermic and sound come together to expose a first class **WELL BEING** environment.





Emilean
RESIDENCE

INTERIOR SPECIFICATIONS

- 200mm exterior facing walls with partition walls between apartments
- Nolte bespoke German kitchen cabinets
- Bosch integrated appliances with built-in fridge and freezer (electric hob and extractor; oven; microwave; washing machine)
- Fully-fitted bathrooms with Grohe fixtures + first-choice porcelain designer tiles
- Engineered paneled / flush doors with hardware
- Technal glazed aluminum windows and doors
- Tempered glass balustrades
- Wardrobes in all bedrooms
- Recessed ceiling lighting
- Daikin air conditioned units
- Fiber optic internet connectivity
- HD DSTV connection
- + Or equivalent





Emilean
RESIDENCE

FEATURES & FACILITIES

- Floating Conference Room (Ground Floor)
- 2 passenger lifts
- 1 service lift
- Fully equipped gym with external garden (1st Flr.)
- Kids playground (Ground Floor)
- Staff changing rooms and canteen
- 1 basement parking
- Fire escape staircase
- Backup power generator
- 24-hour security and concierge service
- Refuse collection room
- Facility maintenance team
- Fire prevention & safety protection system



GROUND FLOOR PLAN

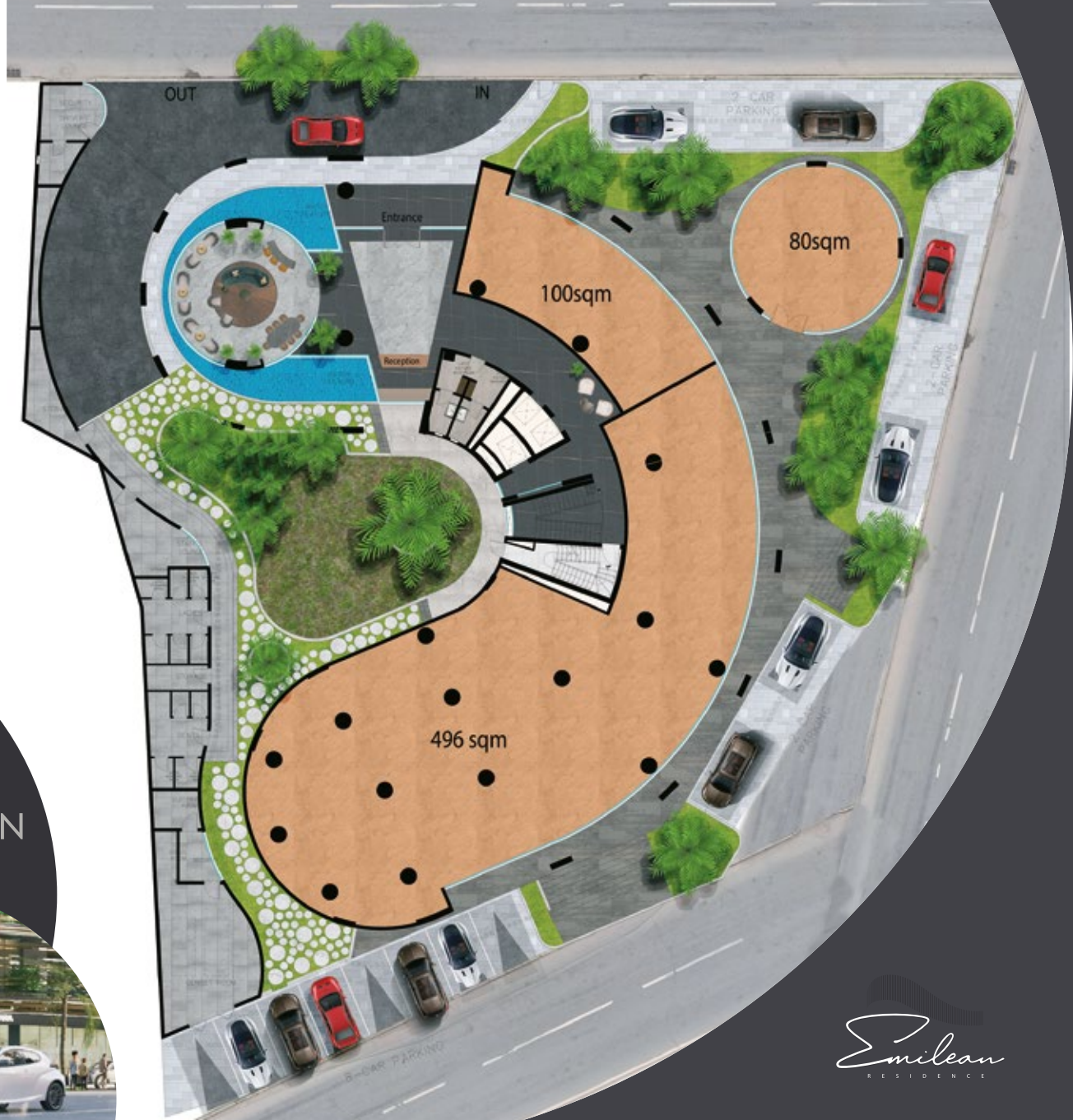



1ST FLOOR PLAN

ONE BEDROOM APARTMENTS : 84sqm²
TWO BEDROOM APARTMENTS : 125sqm²





2ND FLOOR PLAN

1 BEDROOM APARTMENTS : 84 sqm²

2 BEDROOM APARTMENTS : 128 sqm²

3 BEDROOM DUPLEX APARTMENTS : 322 sqm²

3 BEDROOM APARTMENTS : 230 sqm²



3RD FLOOR PLAN

- 1 BEDROOM APARTMENTS : 80 sqm²
- 2 BEDROOM APARTMENTS : 120 sqm²
- 3 BEDROOM APARTMENTS : 241 sqm²

4TH FLOOR PLAN

THREE BEDROOM EXECUTIVE APARTMENTS

467 sqm²





5TH FLOOR PLAN

THREE BEDROOM EXECUTIVE APARTMENTS

450 sqm²



LOCATION

Located on the corner of one of Cantonment's most vibrant yet relaxed streets, & embracing an aesthetically pleasing landscape, The **Emilean** Residence unfolds a polished style and display of amenities that ensure flawless comfort in each home. Every apartment offers an elaborate living area, a fully equipped modern kitchen, spacious walk-in closets and private terraces, allowing for the ideal **URBAN RETREAT**.

To get online PDF of the Brochure
Scan the QRCode



R E S I D E N C E
UNRIVALED CLASS

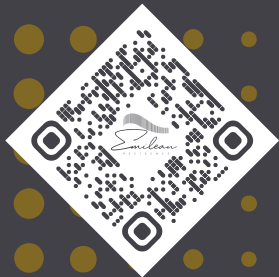

Emilean

R E S I D E N C E



Accra, GHANA
#10, 5th Circular St. Cantonments, Accra
T.: +233 (0) 302 798 005 /6
M.: +233 (0) 05 96 994 779
E.: yourbestapartment@roots-hospitality.com